

1760 MARKET STREET

PHILADELPHIA, PA 19103

SUITE 1204 | LAST SMALL SPACE AVAILABLE | 1,490 RSF



KEY HIGHLIGHTS

- Available March 1, 2022
- Abundance of natural light
- Kitchen and File Storage Areas
- Overlooks 18th Street
- Newly renovated restrooms and corridor

BE PART OF THE "18TH STREET EXPERIENCE"

1760 Market is located adjacent to Rittenhouse Square's lively restaurants, cafés, bars, and shops while remaining linked to the business and technology hub along Market Street.

BUILDING FEATURES

- Sophisticated boutique environment
- On-site building management
- Keystone Innovation Zone opportunity
- Tenant lounge and Building conference center
- Designated bike room
- 24/7 manned security desk



STOCKTON
REAL ESTATE ADVISORS

1760 Market Street, Suite 900
Philadelphia PA 19103

For more information,
please contact:

James Paterno
E: jpaterno@stocktonrea.com
M: 215-840-1930
O: 215-636-4440

17
60
MKT

1760 MARKET STREET

PHILADELPHIA, PA 19103

SUITE 1204 | LAST SMALL SPACE AVAILABLE | 1,490 RSF

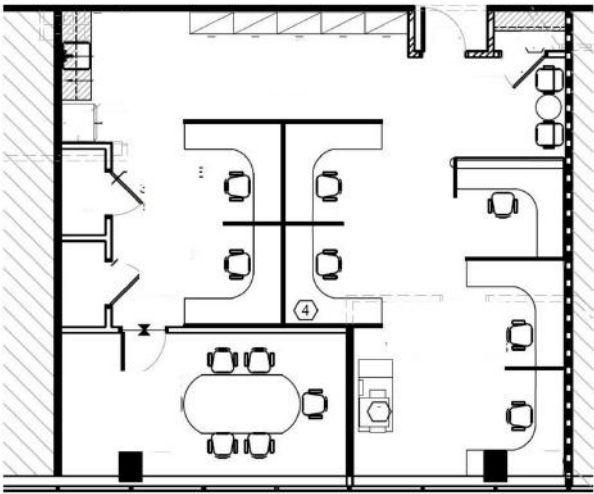

LOCATION HIGHLIGHTS

- Located 2 blocks from Rittenhouse Square and 4 blocks from City Hall
- Exceptionally walkable location surrounded by numerous restaurants, hotels, and parks
- Immediate access to the Concourse and Suburban Station

Steps away...

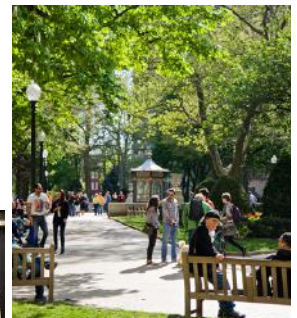

WALK SCORE

TRANSIT SCORE



100



100



STOCKTON
REAL ESTATE ADVISORS

1760 Market Street, Suite 900
Philadelphia PA 19103

For more information,
please contact:

James Paterno

E: jpaterno@stocktonrea.com

M: 215-840-1930

O: 215-636-4440